

# MANUAL

english

# THE Y SURF

GB

## Y Surf Manual

### *Welcome*

Thank you for buying a Carry Freedom Y-Surf attachment for your Y-large trailer. These instructions will help you get the most out of your new Y accessory.

Read these instructions carefully before use.

### **IMPORTANT:**

It is your responsibility to understand these instructions. We do not accept responsibility for how you use, modify, ride, or load the trailer. You must decide if what you are doing with the trailer is safe, within your ability, and within the law. Please check your highway laws concerning bicycles and trailers.



carry  
freedom  
a bike trailer revolution



## Parts List

- 1** 2 x u-shaped side bar
- 2** 2 x adjustment post
- 3** 2 x crossbar
- 4** 2 x foam for crossbar
- 5** 4 x square rubber tube cap
- 6** 4 x bolt/washer/binder bolt for adjustment post assembly M6
- 7** 4 x rubber cap round for crossbar
- 8** 4 x rounded plastic saddle washer, bolt and washer for crossbar assembly M8
- 9** 4 x eye ring and spring washer
- 10** 4 x bolt/washer/washer/nyloc nut M6

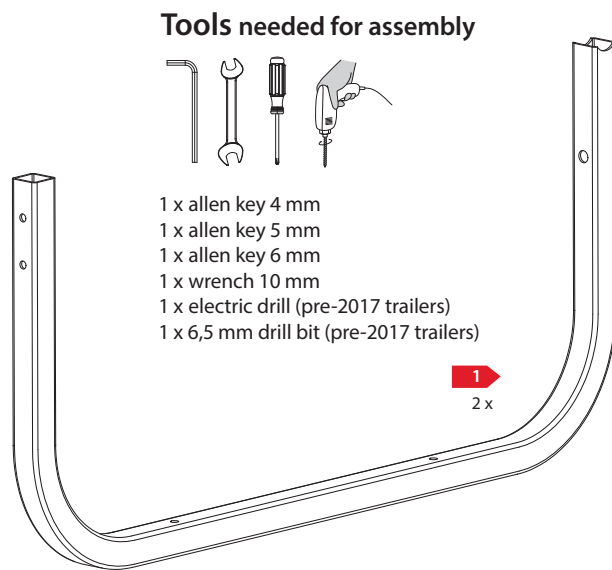
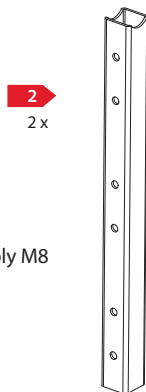
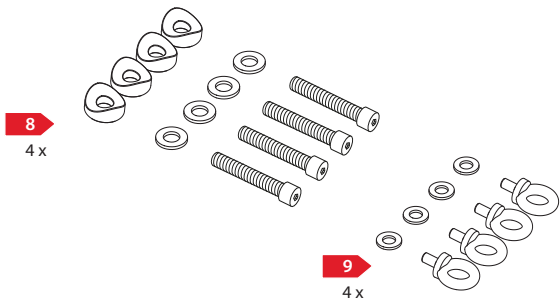
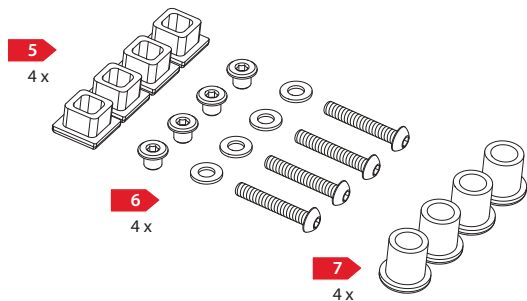

## Tools needed for assembly

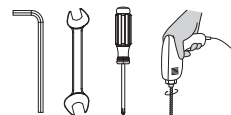

- 1 x allen key 4 mm
- 1 x allen key 5 mm
- 1 x allen key 6 mm
- 1 x wrench 10 mm
- 1 x electric drill (pre-2017 trailers)
- 1 x 6,5 mm drill bit (pre-2017 trailers)

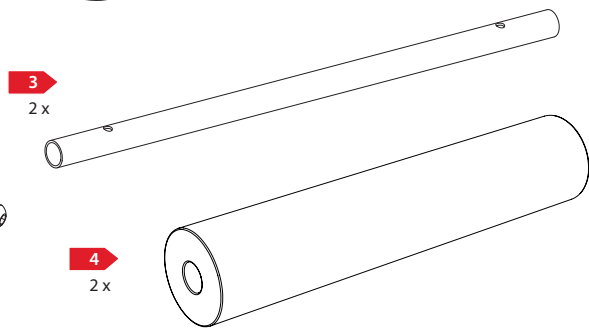

## Assembly Y-Surf

- 1 First assemble the frame construction.  
Push the four square rubber caps into the flat end of the adjustment post and the flat end of the U-shaped sidebars
- 2 Fix the post to the two U-shaped side bars, making sure that the flat end of the U-shaped side bar is where the connection is made. Use the bolt, washer and binder bolt assembly pack (#6) for this step. We also recommend a drop of loctite in the binder bolt.

There are three height positions:

- the level position for all long loads, like paddle boards, ladders, cellos etc.
- the middle position for middle to long loads
- the highest position for surfboards/short loads

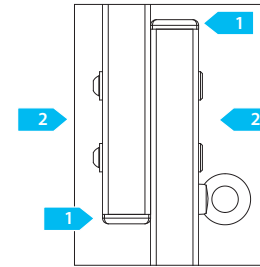
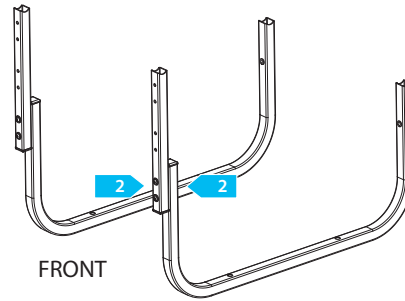

- 3 Push the round rubber caps into the holes on the crossbar. Push the crossbar through the foam.
- 4 Assemble the first crossbar to the two adjustments posts using the saddle washer, washer and bolt (#8). In the post is a star nut already inserted for the bolts. The second crossbar is now fixed in the same way to the other end of the U-shaped sidebars.
- 5 Place the assembled frame on the load bed.

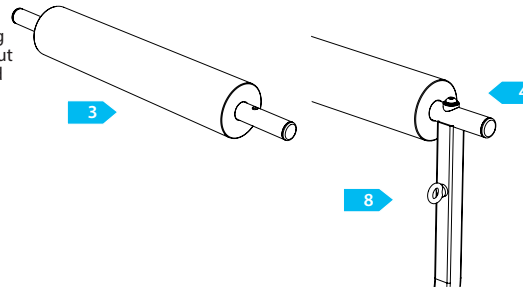

These holes must be drilled if you are using a pre 2017 Y trailer

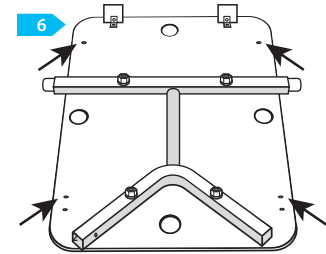

These holes are already drilled on 2015-2016 trailers

1. All 2017 trailers have holes pre-drilled for the Y-Surf
2. Some Y large load beds (2015-2016) have two holes on each side for the deflection device. Use the second hole to fix the front end of the Y-Surf to the load bed, using the bolts, washers and nuts. Make sure the Y-Surf is positioned parallel to the side of the load bed. Then mark the position and using a sharp drill with a fast rotation and light pressure to avoid splintering, drill the two holes needed for the rear fixing of the frame.
3. If your Y Large load bed has no holes drilled for the Y-Surf, then use the Y-Surf as a drill template. Place the assembly on the load bed being sure that the adjustment posts are facing to the front of the trailer. Mark the hole positions and using a sharp bit and a drill with fast rotation, drill the four holes needed to fix the surf frame to the load-bed. Use light pressure to avoid splintering.

**Drill tips** - You can reduce splintering by supporting the load bed on a scrap piece of wood, so that the drill goes through the load-bed into the scrap wood.

**WARNING** - The holes in the load bed can be covered by the grip tape. Use a screwdriver to puncture these holes.

- 7 Bolt the surf frame down to the load bed using the assembly pack (#10). The correct order is from the top: bolt/washer/Y surf/load-bed/washer/nyloc nut. Tighten the bolts.
- 8 Last step of the assembly is the fit the eye rings, using the wave washers included (#9). Use the rings as tie down points.

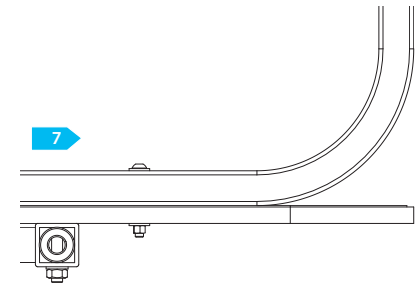
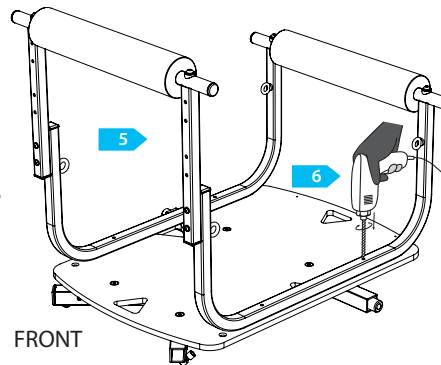

FRONT

## Using the Y-Surf

Make sure that all loads are secured correctly. For carrying surfboards we suggest you use the special ROK straps (available from Carry Freedom) which have special elastic straps that protect the board.

Under the long load is space for carrying more. Watch out for the new waterproof bag that clips to the four round bolts for carrying wet suits, sandwiches and beer. This option will be available from Carry Freedom.

When the Y surf is used in the slanted position, make sure the end of the long load is not too close to the ground. Failure to do this could result in the long load hitting the ground when the angle is too steep. Special care should also be taken when going over kerb stones or holes in the road. See the table below for the maximum length of boards that can be carried in each position, using three different tow arms. The extended tow arms 0.5m and 0.9m are available from your dealer.

Trailer	Tow Arm	High position	Middle position	Level position
Y-large	Standard	max. 250cm - 7ft 10in	max. 250cm - 8ft 2in	max. 130cm - 4ft 3in
Y-large	+0.5 m	max. 300cm - 9ft 10in	max. 320cm - 10ft 5in	max. 220cm - 7ft 2in
Y-large	+0.9 m	max. 330cm - 10ft 9in	max. 350cm - 11ft 5in	max. 300cm - 9ft 10in

If your board is longer than 350cm (11ft 5in) you will need the Loong Arm option, which is almost 3m long and can be shortened as needed.

If your load is wider, we offer two Wide Axle Beams that extend the axle width by 20 or 40 cm.



There are a lot more options for your Y trailer:

**Flag and rear light holder** which can be retrofitted on all Y trailers.

**Kayak holder** - Fits to the load bed of the Y large.

**Tow arm** for the Weber hitch.

**Trailer Snake** - to join more than one Y trailer together.

**Also check out the other trailers in the Carry Freedom portfolio:**

**The LEAF - a shopping travel trailer, light and foldable.**

Contact: USED GmbH - Am Bahnhof 3  
49610 Quakenbrück - Germany  
Tel. +49 (0) 54 31-908 99 80 - info@carryfreedom.com

